

POLISHED WIRED GLASS

The Best Choice Of Fire Resistance Rated Glazing Material!



Office building in Tokyo

Features and Advantages

- High quality glass with a flat and smooth surface
- Produced by a unique and efficient 'DUPLEX' process, which is the only one process all over the world.
- World-wide most cost-effective glazing material for FIRE RESISTANCE!

Applications

- Exteriors and interiors of general construction
- Doors and windows of buildings where fire protection is required
- Locations where fallout protection is required

Mesh Pattern



Diamond Mesh

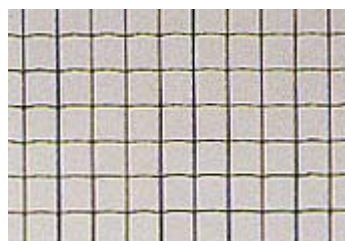

Cross Mesh

Design and Installation Precautions

- When the wired glass is cut, the exposed metal wires are bent and hairline cracks can occur along the glass edges, decreasing strength.
- Exposed metal wires along the edges of the glass can be rusted by rainwater or dew condensation. Wired glass can be damaged due to the spread of rust.
- Maintain an ample distance between the surface of the glass and thick curtains, shades, lockers, etc.

- The glass surface should not be painted or coated with paper.
- The glass surface should not be exposed to direct currents of air from air-conditioning units.
- Calculate and carefully consider thermal values to avoid thermal cracking when a shading or decorative film is put on the glass surface.
- Use a flame-resistant silicone sealing compound when polished wired glass are used as fire door.

Safety Precautions

The building designers are responsible for incorporating specific characteristics of wired glass when determining the applicable locations and area for the glass.

- The primary feature of polished wired glass (diamond and cross mesh) is its fire resistance. These glass products are not safety glazing materials, and should not be used as such or in locations where human impact is possible or where safety glazing is required. However, there is some use of polished wired glass if building regulations require or permit it for such application.

Standard and Performance

- CENTRAL GLASS's polished wired glass (diamond and cross mesh) are listed by Underwriters Laboratories, Inc. of the US as fire resistance rated glazing material 11G4, after tested in accordance with UL9, UL10B and UL10C.

In Japan, it conforms to the fire performance test specified by the Japanese Industrial Standard (JIS R 3204) and the Building Code of Japan.

Type and Specifications			
MESH TYPE	Product code	Standard thickness (mm)	Maximum size (mm)
Diamond	PWH	6.8	3,810 × 2,515
	PWH 10 (Not UL listed)	10.0	4,572 × 2,515
Cross	PWC	6.8	3,810 × 2,515

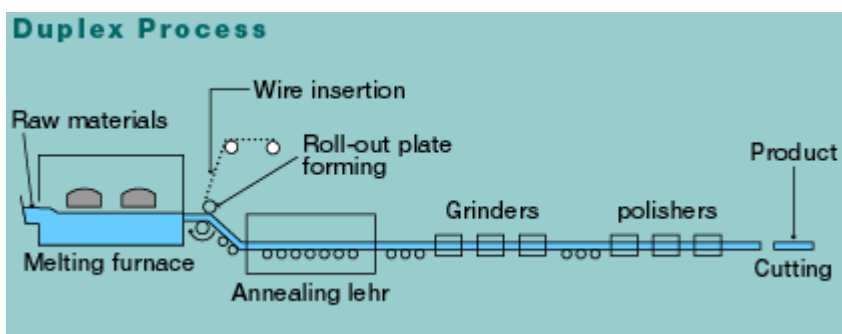

- * **Both glass surface can be ground and polished simultaneously in one continuous operation**

Minimum Values for Clearance and Bite(mm)

Standard thickness (mm)	Curtain wall using sealing compound		
	Face Clearance	Edge clearance	Bite
	a	b	c
6.8	5	7	10
10	5	8	12

Standard Glazing Diagrams

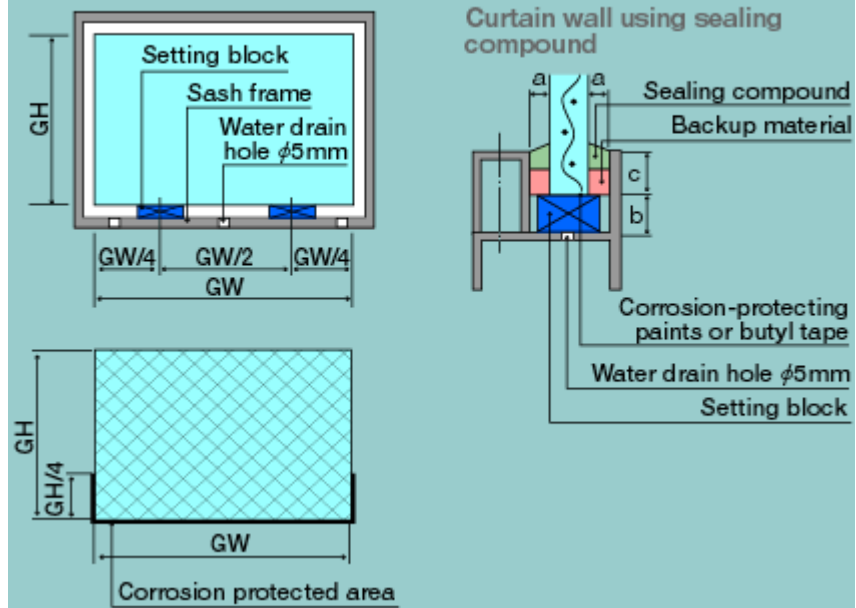

 **CENTRAL GLASS CO., LTD.**

KOWA-HITOTSUBASHI BLDG. 7-1,
KANDA-NISHIKICHO 3-CHOME,
CHIYODA-KU, TOKYO 101-0054 JAPAN

CONTACT : GLASS PRODUCTS EXPORT GROUP
INTERNATIONAL BUSINESS DEPARTMENT
TEL. 81-3-3259-7381 /
FAX. 81-3-3259-7866
E-MAIL. hnoma@cgco.co.jp